

ASTER

1 Bedroom | 1 Bath
Floor Plan: A1

865 SQ FT

Living/Dining Room: 14'9" x 17'2"
Primary Suite 1: 12'9" x 13'5"
Dining Room Balcony: 12'9" x 6'9"



W: ASTERANDLINKS.COM E: ASTERLINKS@GREYSTAR.COM T: 941•308•9200



The information contained herein, including without limitation, any and all artist's or conceptual renderings, plans, stated footages and other information reflected are based on preliminary construction plans, which are subject to change without notice and will vary with actual construction.

ASTER

1 Bedroom | 1.5 Bath
Floor Plan: A3

979 SQ FT

Living/Dining Room: 13'3" x 15'7"

Primary Suite 1: 13'6" x 17'1"

Den: 9'3" x 7'0"

Living Room Balcony: 10'1" x 6'9"



W: ASTERANDLINKS.COM E: ASTERLINKS@GREYSTAR.COM T: 941-308-9200



The information contained herein, including without limitation, any and all artist's or conceptual renderings, plans, stated footages and other information, is based on preliminary construction plans, which are subject to change without notice and will vary with actual construction.

ASTER

3 Bedroom | 3.5 Bath
Floor Plan: B1 Penthouse

2,212 SQ FT

Lower Level:

Living Room: 15'0" x 16'0"

Dining Room: 13'5" x 9'0"

Primary Suite 1: 12'6" x 13'6"

Living Room Balcony: 41'0" x 7'0"

Upper Level:

Primary Suite 2: 12'9" x 13'7"

Primary Suite 3: 13'3" x 13'7"

Loft: 11'3" x 8'0"

Balcony Primary Suite 2: 12'9" x 3'0"

Balcony Primary Suite 3: 11'0" x 3'0"

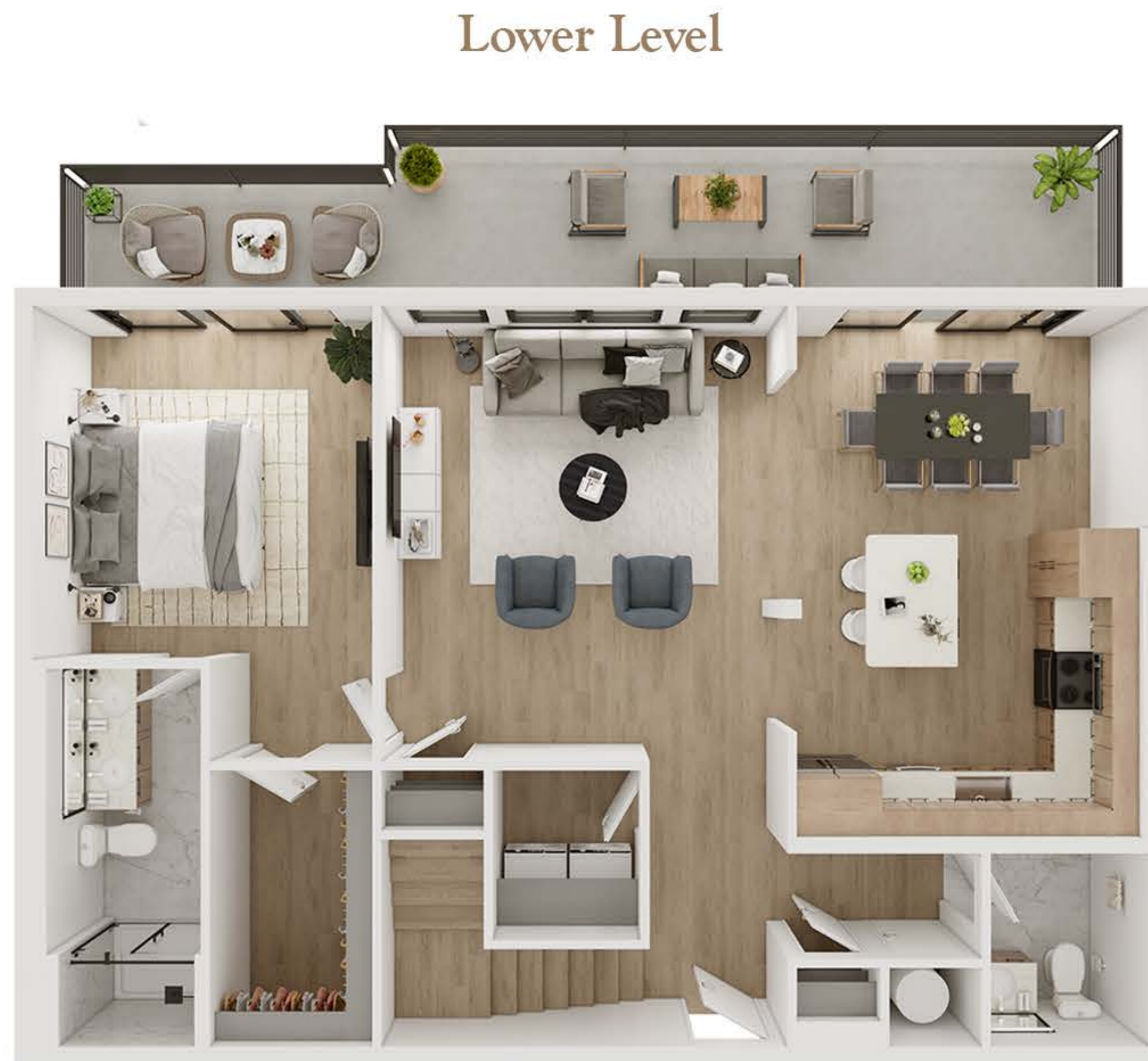

W: ASTERANDLINKS.COM E: ASTERLINKS@GREYSTAR.COM T: 941-308-9200



The information contained herein, including without limitation, any and all artist's or conceptual renderings, plans, stated footages and other information reflected are based on preliminary construction plans, which are subject to change without notice and will vary with actual construction.

ASTER

2 Bedroom | 2.5 Bath
Floor Plan: B3

1,348 SQ FT

Living/Dining Room: 16'0" x 20'4"

Primary Suite 1: 13'3" x 13'6"

Primary Suite 2: 12'9" x 11'9"

Den: 12'9" x 8'0"

Primary Suite 2 Balcony: 12'9" x 6'3"



W: ASTERANDLINKS.COM E: ASTERLINKS@GREYSTAR.COM T: 941-308-9200



The information contained herein, including without limitation, any and all artist's or conceptual renderings, plans, stated footages and other information reflected are based on preliminary construction blueprints; they are not subject to contract and will vary with actual construction.

ASTER

2 Bedroom | 2.5 Bath
Floor Plan: B8



1,469 SQ FT

Living Room: 15'0" x 16'6"

Primary Suite 1: 13'3" x 19'2"

Primary Suite 2: 12'9" x 13'6"

Living Room Balcony: 10'1" x 8'3"

W: ASTERANDLINKS.COM E: ASTERLINKS@GREYSTAR.COM T: 941-308-9200



The information contained herein, including without limitation, any and all artist's or conceptual renderings, plans, stated footages and other information reflected are based on preliminary construction plans, which are subject to change without notice and will vary with actual construction.

ASTER

2 Bedroom | 2.5 Bath
Floor Plan: B9

1,300 SQ FT

Living/Dining Room: 15'0" x 21'5"

Primary Suite 1: 13'3" x 12'9"

Primary Suite 2: 12'9" x 12'2"

Den: 13'3" x 8'6"

Primary Suite 2 Balcony: 12'9" x 7'0"



W: ASTERANDLINKS.COM E: ASTERLINKS@GREYSTAR.COM T: 941-308-9200



The information contained herein, including without limitation, any and all artist's or conceptual renderings, plans, stated footages and other information reflected are based on preliminary construction plans, which are subject to change without notice and will vary with actual construction.

ASTER

2 Bedroom | 2.5 Bath
Floor Plan: B10



1,545 SQ FT

Living Room: 16'0" x 19'6"

Dining Room: 12'9" x 11'10"

Primary Suite 1: 12'0" x 14'11"

Primary Suite 2: 13'3" x 13'5"

Den: 15'0" x 10'0"

Living Room Balcony: 20'0" x 7'0"

W: ASTERANDLINKS.COM E: ASTERLINKS@GREYSTAR.COM T: 941-308-9200



The information contained herein, including illustrations, images and all artist's or conceptual renderings, plans, staged footages and other information reflected are based on preliminary construction plans, which are subject to change without notice and will vary with actual construction.

ASTER

3 Bedroom | 3.5 Bath
Floor Plan: C1 Penthouse

1,348 SQ FT

Lower Level:

Living/Dining Room: 25'6" x 22'0"

Primary Suite 1: 14'9" x 14'0"

Den: 14'0" x 9'11"

Kitchen Balcony: 12'9" x 5'0"

Living Room Balcony: 14'0" x 7'0"

Upper Level:

Primary Suite 2: 14'3" x 14'0"

Primary Suite 3: 14'0" x 13'6"

Loft: 16'6" x 12'9"

Balcony Primary Suite 2: 7'0" x 14'0"

Balcony Primary Suite 3: 17'0" x 7'0"

Lower Level



Upper Level



W: ASTERANDLINKS.COM E: ASTERLINKS@GREYSTAR.COM T: 941-308-9200



The information contained herein, including without limitation, any and all artist's or conceptual renderings, plans, stated features and other information reflected are based on preliminary construction plans, which are subject to change without notice and will vary with actual construction.

ASTER

3 Bedroom | 2.5 Bath
Floor Plan: C1

1,800 SQ FT

Living/Dining Room: 15'0" x 22'3"

Primary Suite: 13'6" x 14'0"

Bedroom 1: 11'10" x 12'9"

Bedroom 2: 14'0" x 13'6"

Bedroom 1 Balcony: 7'1" x 12'9"



W: ASTERANDLINKS.COM E: ASTERLINKS@GREYSTAR.COM T: 941•308•9200



The information contained herein, including without limitation, any and all artist's or conceptual renderings, plans, stated footages and other information reflected are based on preliminary construction plans, which are subject to change without notice and will vary with actual construction.